

UNIVERSITY OF SWAZILAND
FACULTY OF HEALTH SCIENCES
DEPARTMENT OF ENVIRONMENTAL HEALTH SCIENCE
RE_SIT EXAMINATION PAPER JULY 2017

TITLE OF PAPER : BUILDING CONSTRUCTION
TECHNOLOGY II

COURSE CODE : EHM 305

DURATION : 2 HOURS

MARKS : 100

INSTRUCTIONS : ANSWER ANY FOUR QUESTIONS

: EACH QUESTION CARRIES 25 MARKS

: BEGIN EACH QUESTION ON A
SEPARATE SHEET OF PAPER

**DO NOT OPEN THIS QUESTION PAPER UNTIL PERMISSION IS
GRANTED BY THE INVIGILATOR**

QUESTION ONE

a) Name the following CAD commands and state their function.

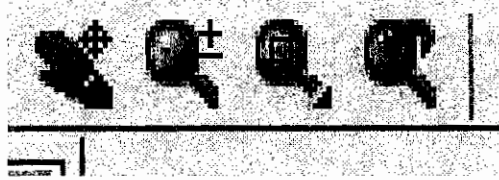

a b c d [4]

b) Given the following CAD functions state the utility thereof



[14]

- c) Outline the planning application procedures & requirements in Swaziland as outlined in the Building Standards Regulations of 1969 [4]
- d) Outline the main issues on the schedules document at the construction site?[3]

QUESTION TWO

- A) A bathroom must have a minimum area of 3.7m² with the least dimension of 1520. Give the dimension of the other side? [5]
- B) AutoCAD uses various cursor modes in trying to execute certain functions. Draw sketches of four of these and indicate the use and meaning thereof. [5]
- C) Draw a sketch to illustrate the point “walls in footings are to be centred on the strip foundation” [10]
- D) What is the value of Base point and Osnap in CAD? [5]

QUESTION THREE

- a) Outline planning steps followed in government construction projects [5]
- b) Given plans for scrutiny what exactly do you look for? [5]
- c) List all the types of architect's drawings you know, their utility and appropriate scales thereof [5]
- d) Given the following figure representing a house exerting a force of 200kn/m² calculate for the required soil bearing capacity of the soil [2]

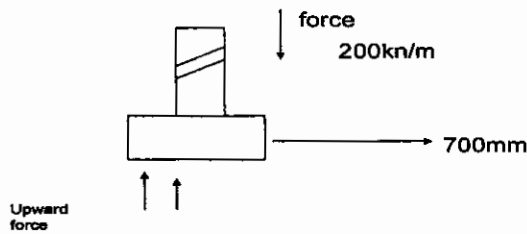

- e) 10mm is the size of a roads driveway leading to a building site. On a scale 1:1000 what is the size of the road? [4]
- f) Give the appropriate titles to indicate the differences between the following CAD commands [4]

LINES and CIRCLES	ERASE, COPY, MIRROR, OFFSET, MOVE, ROTATE, STRETCH
-------------------	--

QUESTION FOUR

- (a) Given the following profile of a one room house plan, lean-to roof, Outline the CAD sequence followed to come up with the elevations, sections and roof thereof. Dimension 2000*1000, door 850, window 1500, roof pitch 10 ° [10]

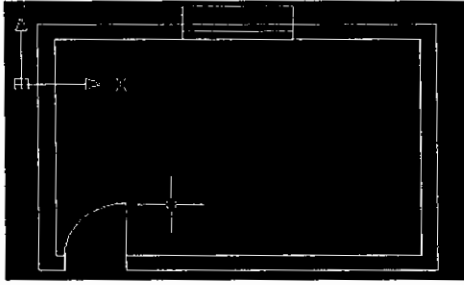

b) Name these two CAD symbols and explain differences thereof

[2]



c) Name these two CAD symbols and explain the difference thereof

[2]



d) Name these two CAD symbols and explain the utility thereof

[2]



e). Given the following representing a door dimension 850. Outline how you go about drawing this in a floor plan. [4]

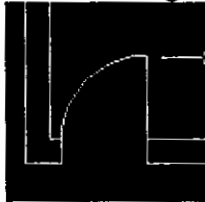

f) Which five CAD commands require that you have the object first before executing it? [5]

QUESTION FIVE

a) Outline the likely expenditure profile (cost) you should plan for in a building project [15]

b) Below is a graphic representing the three project management constraints? Discuss in detail how understanding these is required for a successful construction project. [10]

Project Management Triangle Triple Constraints

